

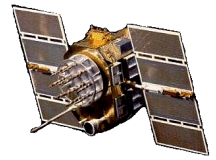

L1/L2 GPS/L-Band (1-2 GHz) Helix Antenna, P/N: 18x6.3H1215R-P-XS-1

2.5" Diameter x 18" Tall, Front/Back Mount Configuration, *for Space Applications*

with SMA, TNC, N, or BNC Connector Options



ISO 9001:2008/FAA Approved Facility

Antenna Mounts: <http://www.antcom.com/documents/catalogs/PeripheralAntennaProducts2.pdf>

ANTCOM CORPORATION . 367 Van Ness Way, #602 . Torrance, CA 90501 . Tel: (310) 782-1076 . Fax: (310) 782-1086 . E-mail: antennas@antcom.com . <http://www.antcom.com>

NOTICE OF PROPRIETARY RIGHTS
THIS DOCUMENT CONTAINS CONFIDENTIAL, TECHNICAL DATA INCLUDING TRADE SECRETS PROPRIETARY TO ANTCOM CORP. DISCLOSURE OF THIS DATA TO YOU IS EXPRESSLY CONDITIONED UPON YOUR AGREEMENT THAT ITS USE IS LIMITED TO USE WITHIN YOUR COMPANY ONLY AND DOES NOT INCLUDE MANUFACTURE OR REPRODUCING HEREIN. ANY OTHER USE IS EXPRESSLY PROHIBITED WITHOUT PRIOR WRITTEN CONSENT OF ANTCOM CORP.

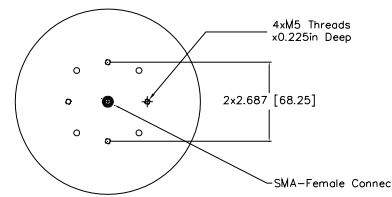
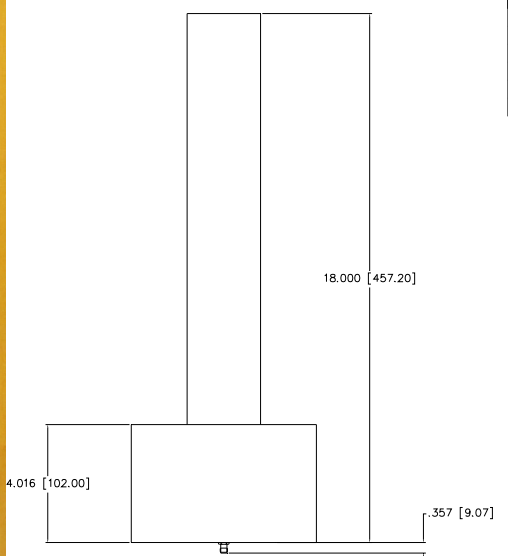
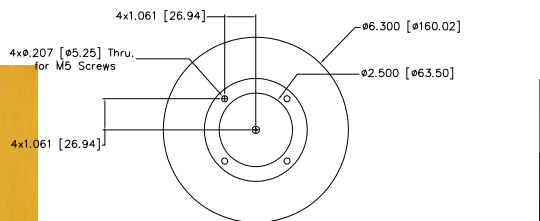
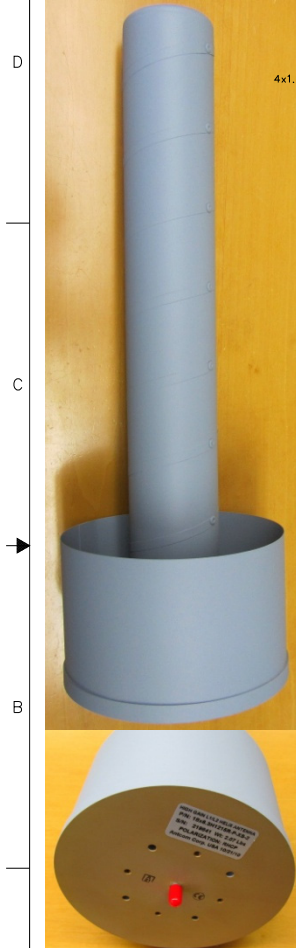

HIGH (in):	POLARIZATION: LL: TX: LHCP, RX: LHCP LR: TX: RHCP, RX: RHCP RL: TX: RHCP, RX: LHCP RR: TX: RHCP, RX: RHCP R: RHCP L: LHCP	LNA: A1: WITH +34 dB LNA P: WITHOUT LNA	CABLE'S LENGTH: X: NO CABLE M: WITH MAG. MOUNT #: CABLE LENGTH (IN) R: RIGHT ANGLE CON.	CONNECTOR: S: SMA, P: PINS M: MCX, MM, MMCX N: N, NB: N-Bulkhead T: TNC, TB: TNC- Bulkhead	COLOR: -1: GLOSS WHITE #17925 PER FED-STD-595B -2: LUSTERLESS GRAY #36320 PER FED-STD-595B -3: OLIVE DRAB GREEN #34031 PER FED-STD-595B -4: LUSTERLESS BLACK #37038 PER FED-STD-595B
------------	---	---	---	--	--

P/N: 18x6.3H1215R-P-XS-1

SPECIFICATIONS

FREQUENCY (MHz):	L5 GPS E5, E5a, E5b, Galileo L5 IRNSS	L2 GPS B2 Compass	L2 GLONASS E6 Galileo B1 Compass	OmniSTAR / L-Band L6 Galileo B1 Compass	L1 GPS E1, E2 Galileo L1 IRNSS	L1 GLONASS
	1176.45 ± 12.0 MHz 1164.45 - 1219.14 MHz 1176.45 ± 15.0 MHz	1227.60 ± 12.0 MHz 1207.14 ± 10.0 MHz	1252.50 ± 7.5 MHz 1266.75 - 1290.75 MHz 1268.52 ± 10.0 MHz	1542.50 ± 14.0 MHz 1542.50 ± 5.0 MHz 1561.098 ± 10.0 MHz	1575.42 ± 15.0 MHz 1575.42 ± 17.0 MHz 1575.42 ± 12.0 MHz	1609.0 ± 7.0 MHz
GAIN (dBic) in FS	+ 11.5 dBic					
AXIAL RATIO (dB)	1 to 2					
RADIATION PATTERN:	HEMISPHERICAL					
POLARIZATION:	RHCP					
VSWR:	< 1.7 : 1					
POWER HANDLING:	200 watts					

MECHANICAL:

SIZE: TOP DIA = 2.50 in [63.50 mm], BASE DIA = 6.30 in[160.02 mm]
 HEIGHT = 18 in. [457 mm]
 WEIGHT: 16.75 oz. (475 +/-10) grams
 FINISH: SKYDROL RESISTANT POLYURETHANE ENAMEL
 BASE IRIDITE PER MIL-C-5541F TYPE II CLASS 1A
 COLOR: GLOSS WHITE #17925 PER FED-STD-595B
 LUSTERLESS GRAY #36320 PER FED-STD-595B
 OLIVE DRAB GREEN #34031 PER FED-STD-595B
 LUSTERLESS BLACK #37038 PER FED-STD-595B
 MATERIAL: 6061-T6 ALUMINUM ALLOY BASE
 COMPOSITE RADOME, IMPACT, ABRASION, UV, SOLVENT,
 AND SKYDROL RESISTANCE, FIRE RETARDANT
 CONNECTOR: SMA-Female
 (OPTION: TNC, TNC-Bulkhead, N, N-Bulkhead, BNC)

ENVIRONMENTAL:

TEMPERATURE: -166 °F TO +248 °F [-110 °C TO +120 °C]
 ALTITUDE: 70,000 ft.
 VIBRATION: > 30 G's

FEDERAL & MILITARY SPECIFICATIONS:

DESIGN TO: FAA TSO-C144, DO-160D, D0-228, MIL-C-5541F, MIL-E-5400, MIL-I-45208A, MIL-STD-810, AND SAE J1455

QUANTITY REQD	DESCRIPTION	PART NO	FINISH	ITEM NO
4	MOUNTING SCREW: (M5 Pan Head Phillips, 10mm)	90116A250	-	5
4	MOUNTING SCREW: (M5 Pan Head Phillips, 20mm)	90116A260	-	4
1				3
1				2
1				1

UNLESS OTHERWISE SPECIFIED DIMENSIONS ARE IN INCHES
 FRACTIONS TO BE DECIMALS
 ± 1/64
 .005
 .005 ± 1°
 TOLERANCE SURF PER AMS Y14.5
 REMOVE ALL BURRS
 BREAK EXTERNAL EDGES .000 TO .015
 FILLETS R .000 TO R .030
 SQUARE THREADS PER UNF-3-1879
 DIA'S ON A CANNOTION ± .005
 MACHINED SURFACES
 DO NOT SCALE DRAWING

ANTCOM CORP. TORRANCE CALIFORNIA
 HIGH GAIN
 GPS/GLONASS/IRIDIUM/
 INMARSAT HELIX ANTENNA

ENGINEER: S. HUYNH
 DEC-07-09
 D 3CVE1
 18x6.3H1215R-P-XS-1
 SCALE 1/1
 SHEET 1 OF 1

NMO Connector Option is Now Available for Some Antennas