

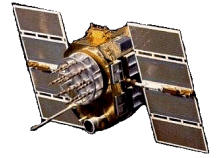

Active or Passive L1/L2 GPS Antenna, P/N: 1.2G1215X-XS-X Rev C

(Improved Gain) 1.2" Square, Back Connector Configurations



ISO 9001:2008/FAA Approved Facility

Antenna Mounts: <http://www.antcom.com/documents/catalogs/PeripheralAntennaProducts2.pdf>

ANTCOM CORPORATION . 367 Van Ness Way, #602 . Torrance, CA 90501 . Tel: (310) 782-1076 . Fax: (310) 782-1086 . E-mail: antennas@antcom.com . <http://www.antcom.com>

NOTICE OF PROPRIETARY RIGHTS
THIS DOCUMENT CONTAINS CONFIDENTIAL, TECHNICAL DATA INCLUDING TRADE SECRETS PROPRIETARY TO ANTCOM CORP. DISCLOSURE OF THIS DATA TO YOU IS EXPRESSLY CONDITIONED UPON YOUR ASSENT THAT ITS USE IS LIMITED TO USE WITHIN YOUR COMPANY ONLY (AND DOES NOT INCLUDE MANUFACTURE OR PRODUCTION USES). ANY OTHER USE IS EXPRESSLY PROHIBITED WITHOUT PRIOR WRITTEN CONSENT OF ANTCOM CORP.

SPECIFICATIONS

REVISIONS				
ZONE	REV	DESCRIPTION	DATE	APPROVED
A		3dB More In Gain	Sep-21-06	S.H
C		Connector Flange Thickness	Mar-19-09	S.H

ELECTRICAL:

	L1: (1575.42 ±12) MHz	L2: (1227.60 ±12) MHz
FREQUENCY:		
RADIATION PATTERN:	HEMISPHERICAL	
POLARIZATION:	RHCP	
VSWR:	< 1.5:1	< 1.5:1
IMPEDANCE:	50 ohms	50 ohms
ANTENNA GAIN (dBic):	Free Space 3 in G.P.	Free Space 3 in G.P.
@ 90° (ZENITH):	-0.8 +3.8	-3.7 +2.7
@ 10° Elevation:	-9.3 -4.3	-9.9 -6.3
@ 20° Elevation:	-6.8 -2.2	-9.2 -4.2
@ 30° Elevation:	-5.2 -0.7	-7.8 -2.4
@ 60 - 90° Elevation:	> -2.1 > 2.5	> -4.7 > 1.3
BEAM WIDTH (3dB):	100 Deg. 120 Deg.	100 Deg. 90 Deg.
AXIAL RATIO:	2.5 dB 3	
LIGHTNING PROTECTION:	DC GROUNDING	

LNA OPTION:

LNA GAIN: 24.0 dB
 LNA NOISE FIGURE: 1.8 dB
 LNA P 1dB Out: +16 dBm
 VOLTAGE/CURRENT: (+2.8 TO +28) Volts DC / (15 TO 25) mA

MECHANICAL:

SIZE: 1.250 in. [31.75 mm] SQ.
 HEIGHT: 0.547 in. [13.89 mm]
 WEIGHT: 1.4 oz. (39.2 g)
 FINISH: SKYDROL RESISTANT POLYURETHANE ENAMEL BASE IRIDIUM PER MIL-C-5441
 MATERIAL: 6061-T6 ALUMINUM ALLOY BASE COMPOSITE RADOME, ABRASION, UV, SOLVENT, SKYDROL RESISTANCE, AND FIRE RETARDANT
 CONNECTOR: 4.5" LONG FLEXIBLE CABLE WITH RIGHT ANGLE MMCX (OPTION: MCX, SMA, SMB, SSMA, SSMC, OR TNC)

ENVIRONMENTAL:

TEMPERATURE: -67 °F TO +185 °F [-55 °C TO +85 °C]
 ALTITUDE: 70,000 ft.
 VIBRATION: > 30 G's
 LEAKAGE: HERMETICALLY SEAL

FEDERAL & MILITARY SPECIFICATIONS:

DESIGN TO: FAA TSO-C144, DO-160D, D0-228, MIL-C-5541, MIL-E-5400, MIL-I-45208A, MIL-STD-810, AND SAE J1455

ACCEPTANCE TEST PROCEDURE: ATP-GPS-L1L2-100

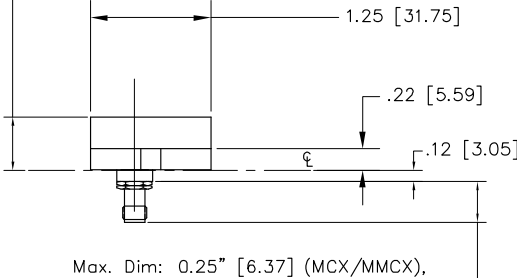
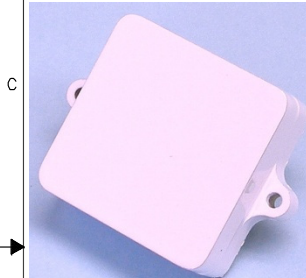
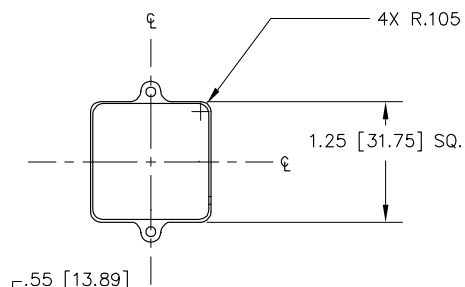
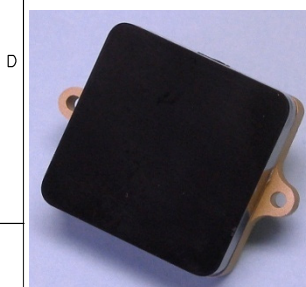

Max. Dim: 0.25" [6.37] (MCX/MMCX),
 0.46" [11.68] (SMA/R-SMA),
 0.57" [14.53] (TNC), 0.83" [21.00] (TNC-BH),
 0.72" [18.29] (N, N-BH)

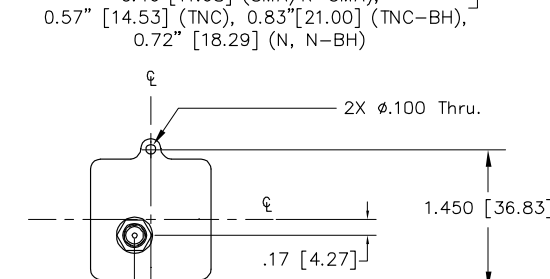
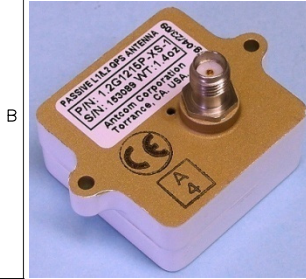

SIZE	FREQ. BAND	LNA:
1: 2" SQ.	1215:L1/L2	A2: WITH 20 dB LNA
1.9: 1.9" SQ.	15: L1 ONLY	A4: WITH 40 dB LNA
2: 2" DIA.		P: WITHOUT LNA
3: 3.5" DIA.		
4: MINIARINC		

P/N: 1.2G1215A2-XS-X

CABLE LENGTH	CONNECTOR	COLOR
X: NO CABLE	S: SMA; RS: R-SMA; P: PINS; M: MCX;	-1: GLOSS WHITE #17925 PER FED-STD-595B
M: MAG. N: NO MAG.	MM: MMCX; SMB; SSMA; SSMC; SSMC;	-2: LUSTERLESS GRAY #36320 PER FED-STD-595B
#: CABLE LENGTH (IN)	SSMP; T: TB; TNC; TNC-Bulkhead	-3: OLIVEDRAB GREEN #34031 PER FED-STD-595B
R: RIGHT ANGLE CON.	L: R-M: Right Angle Male Lemo	-4: LUSTERLESS BLACK #37038 PER FED-STD-595B

QUANTITY	REQD	DESCRIPTION	PART NO	SPECIFICATION	MATERIAL	FINISH	ITEM NO
							5
1		ADHESIVE GASKET	12345G-3M-1.2G				3
1							2
1							1
-2	-1						

UNLESS OTHERWISE SPECIFIED DIMENSIONS ARE IN INCHES
 FRACTIONS DECIMALS ANGLES
 2 1/64 .0015 2 1/2
 300±.005
 TOLERANCE 51M PER ANSI Y14.5
 REPRODUCTION OF THIS DRAWING WITHOUT WRITTEN PERMISSION OF ANTCOM CORP. IS PROHIBITED
 DRAWN BY S. HUYNH
 CHECKED BY S. HUYNH
 APPROVED BY S. HUYNH
 DATE: Mar-11-09
 CAP FILE NO.
 DO NOT SCALE DRAWING

ANTCOM CORP. TORRANCE, CALIFORNIA
 OUTLINE DRAWING
 L1/L2 ACTIVE or PASSIVE
 GPS ANTENNA
 SHEET NO. D1 3CVE1 1.2G1215X-XS-X C
 SCALE 1/1 SHEET 1 OF 1

1. DIMENSIONS IN BRACKETS ARE IN MILLIMETERS [mm]

NOTES: UNLESS OTHERWISE SPECIFIED: