

| Parameter | Unit | Specification | |
|---------------------------|------|--|-------------------|
| Center Frequency(Fo) | MHz | 119 | 340 |
| Band-width(BW) | MHz | 100 ~ 138 MHz | 168 MHz ~ 512 MHz |
| Insertion Loss in BW(max) | dB | 1.0 | |
| Return Loss in BW(min) | dB | 16 | |
| Isolation (min) | dB | 40 @ 110 ~ 140 MHz, 40 @ 190 ~ 410 MHz | |
| Material | | Aluminium alloy | |
| In/Out Impedance | ohms | 50 | |
| Temperature Range | °C | -40 ~ +85 | |
| Power(CW) | W | 50(max) | |
| Connectors | | N-Female | |
| Unit weight | g | 500 | |

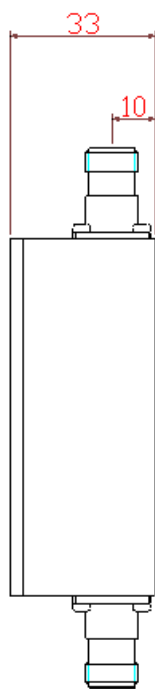

Unit : mm
Tolerance unless
otherwise specified : ±0.2

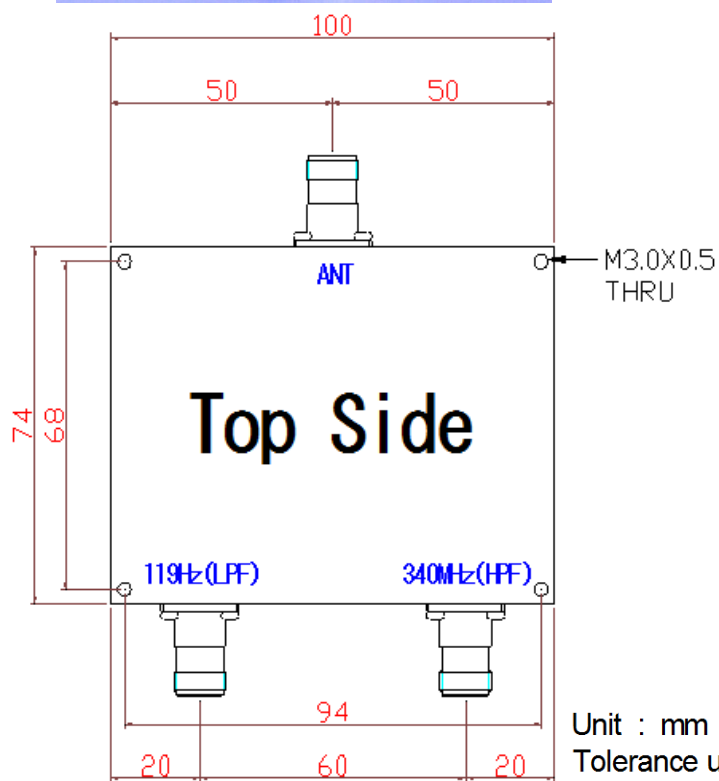